



MY PROPERTY CLUB

MY PROPERTY CLUB
66 Hyde Road, Denton,
Manchester M34 3AG

0161 850 9730

mypropertyclub.co.uk



12 Newport Road Denton, Manchester, M34 7QS

Guide price **£249,000**

Set in a sought-after area this charming property on Newport Road, Denton, offers to the market this semi-detached bungalow that affords a delightful living experience. With two well-proportioned bedrooms, this property is perfect for a variety of buyers or those looking to downsize.

The bungalow is well presented throughout, boasting a modern decorative finish that creates a warm and inviting atmosphere. The spacious living areas are designed to maximise comfort and functionality, making it an ideal space for both relaxation and entertaining.

One of the standout features of this property is the lovely conservatory, complete with a heat roof, which allows for year-round enjoyment of the natural light and garden views. This additional space can be used as a cosy reading nook, a play area, or even a dining space, providing versatility to suit your lifestyle.

Situated close to all local amenities, this bungalow is conveniently located near shops, restaurants, and recreational facilities. Excellent transport links ensure easy access to the wider Manchester area, making commuting a breeze. Furthermore, the proximity to reputable schools adds to the appeal for families.

In summary, this two-bedroom semi-detached bungalow on Newport Road is a fantastic opportunity for those seeking a modern, well-maintained home in a desirable location. With its attractive features and convenient surroundings, it is sure to attract interest from a variety of buyers. Don't miss the chance to make this lovely property your own.

Viewing

Please contact our My Property Club Office on 0161 850 9730 if you wish to arrange a viewing appointment for this property or require further information.

- Two Bedroom Bungalow
- Haughton Green
- Well Presented Throughout
- Popular residential location
- Close to a range of local amenities

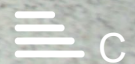

Floor Plan

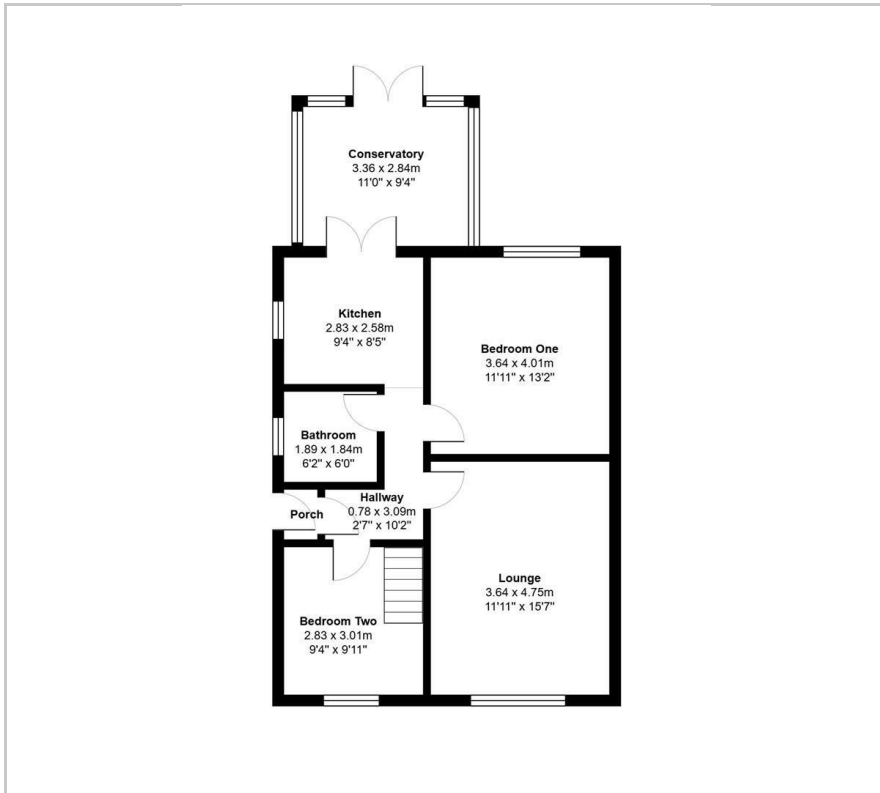

Area Map



Energy Efficiency Graph

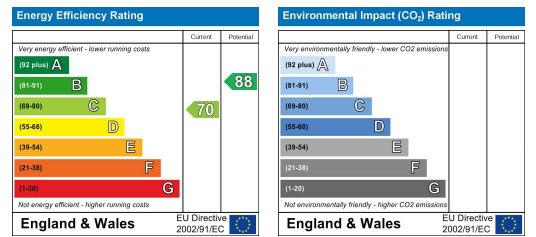

These particulars, whilst believed to be accurate are set out as a general outline only for guidance and do not constitute any part of an offer or contract. Intending purchasers should not rely on them as statements of representation of fact, but must satisfy themselves by inspection or otherwise as to their accuracy. No person in this firm's employment has the authority to make or give any representation or warranty in respect of the property.

66 Hyde Road, Denton, Manchester, M34 3AG
Tel: 0161 850 9730 Email: sales@mypropertyclub.co.uk